

PART NUMBER:



**I-SERIES PROFESSIONAL-GRADE, SOLAR-POWERED LIGHTING SYSTEM FOR EVERY SEASON.** Solera Solar Lighting is the new standard for solar light performance. You can expect a professional-grade, configurable, solar-powered lighting system that provides bright lighting where you want it. With the i-Series line, you can build and remotely program, control and monitor an intelligent solar lighting network. Graphically visualize usage and demand to make the most of your solar lighting.



PROJECT: \_\_\_\_\_

NOTES: \_\_\_\_\_







PART NUMBER BUILDER

BRAND	SERIES	TYPE	OPERATION	LUMENS	BATTERY	OPTICS	MODULE	COLOR	GENERATION	OPTIONS
SL / SOLERA	M / MODULAR	D1 / DECORATIVE LIGHT STYLE 1	OG / OFF-GRID	030 / 3,000	06 / 600 WH	2 / TYPE 2 3 / TYPE 3 4 / TYPE 4 5 / TYPE 5	4 / 4G (PRESENT)	DB / DARK BRONZE	1 / GEN 1	TAA / TAA (TRADE AGREEMENTS ACT)

PART NUMBER:



SPECIFICATIONS	SL-MD1-OG-0300654DB1-TAA
LUMENS	ADJUSTABLE UP TO 3,000
CCT	3000K, 4000K, 5000K SELECTABLE
LIGHT HEAD	STANDARD
PANEL	(2) 55W
BATTERY	600 WH
EPA	9.0

FEATURES	
ADJUSTABLE CCT & LIGHT OUTPUT	
RETROFIT KITS OR COMPLETE POLE KITS AVAILABLE	
LIGHTER WEIGHT PANEL & BATTERY	
SOLERA CONNECT COMPATIBLE	
PROGRAM GROUPS & SCHEDULES REMOTELY	
MONITOR SOLAR HARVEST, BATTERY STATE & LIGHTING BEHAVIOR	
CAPTURE USAGE DATA FOR SUSTAINABILITY REPORTING	

TAA



STANDARD



OPTIONAL\*



FULL POWER ALL NIGHT\*\*



BATTERY CHARGE TIME



BATTERY LIFE\*\*



BATTERY CHANGE TEMP



OPERATING TEMP  
-40°F TO 140°F



REPLACEABLE BATTERY



OPTIONAL MOTION SENSING



100,000hrs RATED LIFE

### SOLAR AREA LIGHT ACCESSORIES

PART #	DESCRIPTION	PART #	DESCRIPTION
SL-AL1-SHIELD-1	BACK LIGHT SHIELD	SL-AL1-LENS-T3	LENS SET TYPE 3 OPTICS (STANDARD)
SL-AL1-SHIELD-2	FULL CUTOFF SHIELD	SL-AL1-LENS-T4	LENS SET TYPE 4 OPTICS
SL-AL1-LENS-T2	LENS SET TYPE 2 OPTICS	SL-AL1-LENS-T5	LENS SET TYPE 5 OPTICS

\* OPTIONAL 10 YEAR WARRANTY WILL HAVE AN ADDED COST  
\*\* BATTERY LIFE DEPENDS ON ENVIRONMENT AND POWER SETTING

PART NUMBER:

SL-MD1-OG-0300654DB1-TAA DIMENSIONS

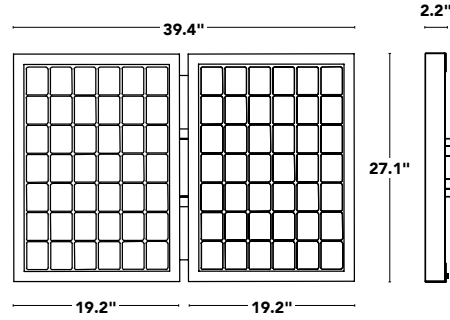
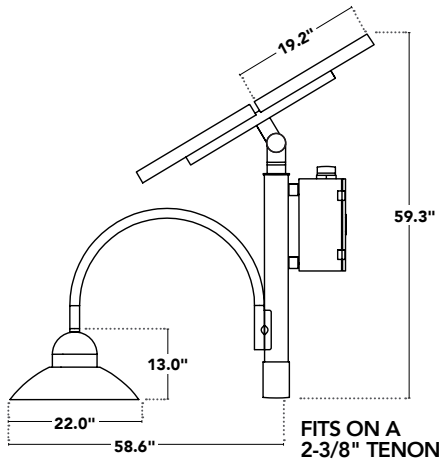

PART NUMBER:

Solera Connect provides real-time visibility into your solar lighting assets through web and mobile access. Using 4G connectivity, users can remotely monitor performance, adjust operating schedules, program lighting profiles and respond to alerts from any location.

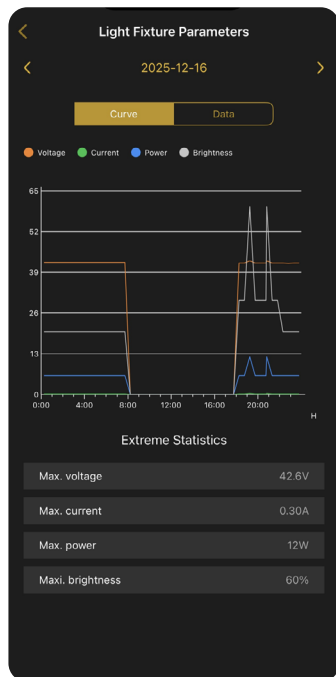
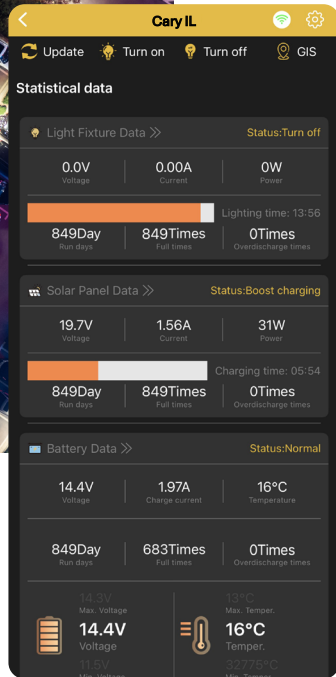

- Remote monitoring and control via web portal or mobile app
- Carrier agnostic 4G LTE connectivity ensures connectivity across North America
- One cellular connection per fixture for independent, reliable monitoring
- Pre-commissioned fixtures from the factory simplify installation for easy in-field set up
- App available on Android and IOS
- GIS-based map displays fixture status, alarms and system health at a glance
- Preset programming modes simplify commissioning and seasonal adjustments
- Site grouping and zone-based controls for parks, roadways and campuses
- Automated alarms with work order generation and service confirmation
- Emissions reduction reporting supports sustainability and grant requirements

DOWNLOAD SOLERA CONNECT APPS

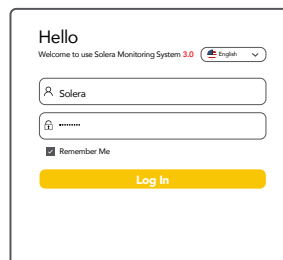

MOBILE APP Solera.  
WEB APP lampmonitor.com

PART NUMBER:

**RECOMMENDED POLE OPTIONS**

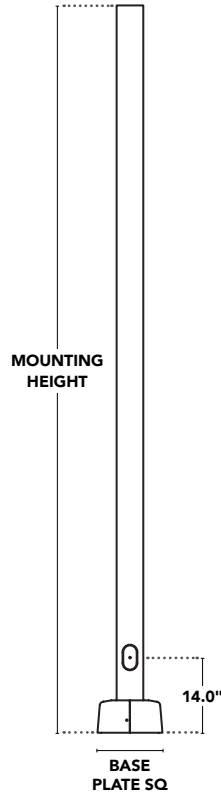

**SQUARE, STRAIGHT STEEL ANCHOR BASE**

PART #	MOUNTING HEIGHT	SHAFT DIAMETER	WALL THICKNESS	ANCHOR BOLT DIAMETER	BASE PLATE SQ	BASE PLATE HEIGHT
SL-RPSQ-20-5-7-AB-T2-XX	20 FT	5.0"	7 GA	1" X 40"	11.0"	1"
SL-RPSQ-25-6-7-AB-T2-XX	25 FT	6.0"				
SL-RPSQ-30-6-7-AB-T2-XX	30 FT	6.0"			12.0"	

**SQUARE, STRAIGHT STEEL DIRECT BURIAL**

PART #	MOUNTING HEIGHT	SHAFT DIAMETER	WALL THICKNESS	BURIAL DEPTH
SL-RPSQ-20-5-7-EMB-T2-XX	20 FT	5.0"	7 GA	4 FT
SL-RPSQ-25-6-7-EMB-T2-XX	25 FT	6.0"		5 FT
SL-RPSQ-30-6-7-EMB-T2-XX	30 FT	6.0"		

XX = FINISH COLOR, BK = BLACK, DB = DARK BRONZE, GR = GRAY

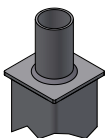

POLES INCLUDE 2.38" OD X 4.0" TENON ON THE TOP  
**POLES ARE CUSTOM MADE TO ORDER AND ARE NOT RETURNABLE**

PART NUMBER:

<b>LIGHT ENGINE</b>		<b>SL-MD1-OG-0300654B1-TAA</b>
ENGINE	AL-101	
LED	192 LED. 3030 HIGH EFFICACY	
MAX. POWER	20W	
EFFICACY	160+ LUMENS PER WATT	
CRI	70+	
MAX. LUMENS	3,000 LUMENS	
CCT	3000K, 4000K, 5000K SELECTABLE	
CONTROLLER	MPPT CHARGE CONTROLLER	
HYBRID OPTION	N/A	
4G OPTION	4G MODULE FOR SOLERA CONNECT	
STANDARD OPTICS	TYPE 5	
OPTICS OPTIONS	TYPE 2, TYPE 3, TYPE 4, TYPE 5	
SHIELD OPTIONS	BACK LIGHT SHIELD, FULL CUTOFF SHIELD	
RATED LIFE	L70 / 10,000 HOURS	
<b>SOLAR PANEL</b>		
TYPE	MONOCRYSTALLINE	
WATTS	55W PER PANEL	
VOLTAGE	12V	
ADJUSTABLE	ANGLE AND ROTATION ARE FULLY ADJUSTABLE	
CHARGE TIME	6 HOURS	
DIMENSIONS	27.1" X 19.2" X 2.2" (NOT INCLUDING SLIP-FITTER)	
WEIGHT	38.50 LB	
INGRESS PROTECTION	IP65	
<b>BATTERY</b>		
TYPE	LIFEPO4	
CHARGING TEMP	-4° TO 140°F	
DISCHARGING TEMP	-40° TO 140°F	
CHARGING TIME	6 HRS	
BATTERY LIFE	30 HRS (BASED ON ENV / PWR SETTINGS)	
REPLACEABLE	YES	
CHARGE CYCLES	2000+	
AMPERE-HOURS	47	
WATT HOURS	600	
WEIGHT	11.4 LBS	
BMS SYSTEM	ONBOARD FULL PROTECTION	
SAFETY	UN 38.3	
<b>AREA LIGHT ASSEMBLY</b>		
DESCRIPTION	MEDIUM	
SOLAR PANEL	2 X 55W	
BATTERY	600 WH	
LIGHT HEAD	20W / 10,000 LUMENS	
EPA	9.0 FT <sup>2</sup>	
WEIGHT	TBD	